

B800S-MEDGML



B800S-MDDGML
Custom length



B800S-MEDGOL

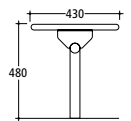
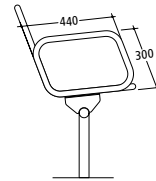
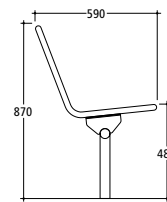

B800 Wire mesh



Available in hot-dip galvanized and powder-coated steel. Standard color: charcoal-ironglimmer, similar to DB 703. Optionally w/ armrest.
Version for embedding in concrete or for free-standing installation.

B800 continuous wire mesh

Available lengths: 1.500 and 1.800 mm (w/o armrest)
Subframe tube $\varnothing = 48$ mm

B800 Single seat wire mesh

Available lengths: 500, 1.050, 1.600, 2.150 and 3.250 mm (w/o armrest)
Subframe tube $\varnothing = 48$ mm

Seating element with backrest

B800S-SDDGML for embedding in concrete
B800S-MDDGML for free-standing installation

Seating element w/o backrest

B800S-SDDGOL for embedding in concrete
B800S-MDDGOL for free-standing installation

Seating element with backrest

B800S-SEDGML for embedding in concrete
B800S-MEDGML for free-standing installation

Seating element w/o backrest

B800S-SEDGOL for embedding in concrete
B800S-MEDGOL for free-standing installation