

T300V-MHO with B300 Bench

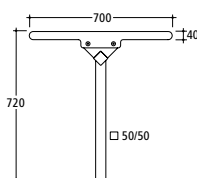

T300V-SLB with B300 benches

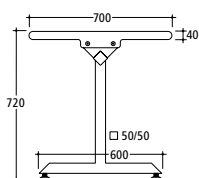

T300V



Matching table for series B300.

Stainless steel - bead-blasted and electro-polished to a matte finish or powder-coated finish. Standard color: charcoal-ironglimmer, similar to DB 703.

Available lengths: 1.500 and 1.800 mm
wood slats 45 x 28 mm (FSC® hardwood, untreated), perforated sheetmetal with 7 mm

T300V – wood slats

T300V-SHO for embedding in concrete
T300V-MHO for free-standing installation

T300V – perforated sheetmetal

T300V-SLB for embedding in concrete
T300V-MLB for free-standing installation